

SISTEMAS MODULARES / MODULAR SYSTEMS / SISTEMAS MODULARES.

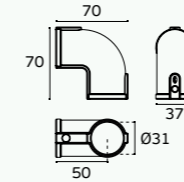

IN.09.001
Curva / Elbow / Curva

MATERIAL: EN 1.4301 / AISI 304
ACABAMENTO / FINISH : RAW



IN.09.002
União / Union / Unión

MATERIAL: EN 1.4301 / AISI 304
ACABAMENTO / FINISH : RAW

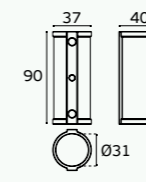

IN.09.003
Conector / Connector / Conector

MATERIAL: EN 1.4301 / AISI 304
ACABAMENTO / FINISH : RAW

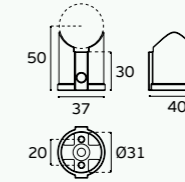

IN.09.004
Base / Base / Base

MATERIAL: EN 1.4301 / AISI 304
ACABAMENTO / FINISH : RAW

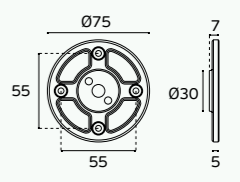

IN.09.005.1
Conector / Connector / Conector

MATERIAL: EN 1.4301 / AISI 304
ACABAMENTO / FINISH : RAW

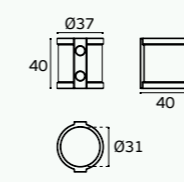

IN.09.010
União / Union / Unión

MATERIAL: EN 1.4301 / AISI 304
ACABAMENTO / FINISH : RAW

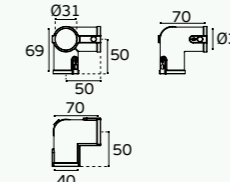

IN.09.011
União / Union / Unión

MATERIAL: EN 1.4301 / AISI 304
ACABAMENTO / FINISH : RAW

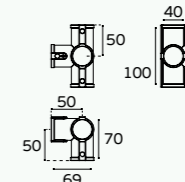

IN.09.012
União / Union / Unión

MATERIAL: EN 1.4301 / AISI 304
ACABAMENTO / FINISH : RAW

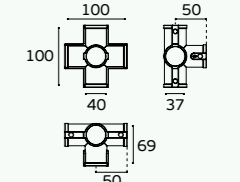

IN.23.600.30.1000
IN.23.600.30.2000
IN.23.600.30.3000
Tubo / Tube / Tubo

MATERIAL: EN 1.4301 / AISI 304
ACABAMENTO / FINISH : RAW

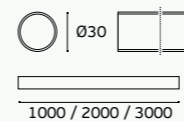

IN.09.004.1
Tampa de remate / Finishing cap / Cubierta de remate

MATERIAL: EN 1.4301 / AISI 304
ACABAMENTO / FINISH : RAW

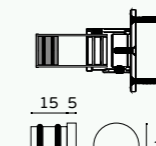

IN.09.008
Reforço interior de tubo / Inner tube reinforcement / Refuerzo interior de tubo.

MATERIAL: ALUMINIO / ALUMINIUM

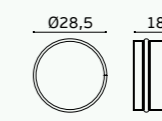

IN.09.006
Base interior de fixação / Inner fixing base / Base interior fijación

MATERIAL: ALUMINIO / ALUMINIUM



IN.09.007
Base interior de fixação / Inner fixing base / Base interior fijación

MATERIAL: ALUMINIO / ALUMINIUM