



ARCHITECTURAL  
HARDWARE

# CONNECT SYSTEMS

●  
THINK

●  
CONNECT

●  
BUILD



## JNF CONNECT SYSTEMS

**SISTEMA MODULAR PARA CRIAR ESTRUTURAS SIMPLES, COMO MOBILIÁRIO, ELEMENTOS DECORATIVOS, DIVISÓRIAS ESTRUTURAIS, ETC.**

**OS ELEMENTOS SÃO PRODUZIDOS EM AÇO INOXIDÁVEL AISI 304 POR FUNDIÇÃO, O ACABAMENTO É RAW, OBTENDO UM ASPETO MATE E UMA SENSÇÃO SUAVE AO TOQUE. ADICIONALMENTE, ESTES COMPONENTES PODEM SER PRODUZIDOS COM ACABAMENTO PVD EM DIFERENTES CORES COMO PRETO, COBRE OU DOURADO.**

**O SISTEMA DE FIXAÇÃO É MUITO FÁCIL, APENAS COM PARAFUSOS ALLEN QUE GARANTEM O APERTO NECESSÁRIO DE TODOS OS ELEMENTOS.**

MODULAR SYSTEM USED TO CREATE EASY STRUCTURES LIKE FURNITURE, DECORATIVE ELEMENTS, STRUCTURAL FENCES, ETC.

THE ELEMENTS ARE PRODUCED IN STAINLESS STEEL AISI 304 BY CASTING, THE FINISH IS RAW GETTING A MATTE LOOK AND SMOOTH TOUCH FEELING. ADDITIONALLY THESE COMPONENTS CAN BE PRODUCED WITH PVD FINISH IN DIFFERENT COLORS LIKE DEEP BLACK, COPPER OR GOLD.

THE FIXING SYSTEM IS VERY EASY, JUST ALLEN SCREWS MAKE THE NECESSARY TIGHTENING OF ALL ELEMENTS.

SISTEMA MODULAR PARA CONSTRUIR ESTRUTURAS SIMPLES, COMO MOBILIARIO, ELEMENTOS DECORATIVOS, DIVISIONES ESTRUCTURALES, ETC.

LOS ELEMENTOS SON PRODUCIDOS EN ACERO INOXIDABLE AISI 304 POR FUNDICIÓN, EL ACABADO ES RAW OBTENIENDO UN ASPECTO MATE Y UNA SENSACIÓN SUAVE AL TOQUE. ADEMÁS, ESTOS COMPONENTES SE PUEDEN PRODUCIR CON ACABADO PVD EN DIFERENTES COLORES COMO NEGRO PROFUNDO, COBRE O DORADO.

EL SISTEMA DE FIJACIÓN ES MUY FÁCIL, SÓLO TORNILLOS ALLEN HACEN EL APRIETE NECESARIO DE TODOS LOS ELEMENTOS

THINK - CONNECT - BUILD





**IN.09.001**  
Curva / Elbow / Curva

MATERIAL: EN 1.4301 / AISI 304

ACABAMENTO / FINISH: RAW

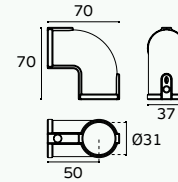

**IN.09.002**  
União / Union / Unión

MATERIAL: EN 1.4301 / AISI 304

ACABAMENTO / FINISH: RAW

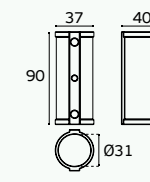

**IN.09.003**  
Conector / Connector / Conector

MATERIAL: EN 1.4301 / AISI 304

ACABAMENTO / FINISH: RAW

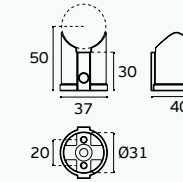

**IN.09.004**  
Base / Base / Base

MATERIAL: EN 1.4301 / AISI 304

ACABAMENTO / FINISH: RAW

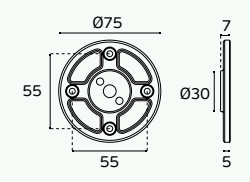

**IN.09.005.1**  
Conector / Connector / Conector

MATERIAL: EN 1.4301 / AISI 304

ACABAMENTO / FINISH: RAW

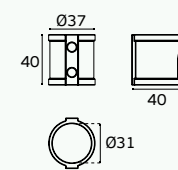

**IN.09.010**  
União / Union / Unión

MATERIAL: EN 1.4301 / AISI 304

ACABAMENTO / FINISH: RAW

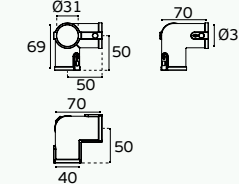

**IN.09.011**  
União / Union / Unión

MATERIAL: EN 1.4301 / AISI 304

ACABAMENTO / FINISH: RAW

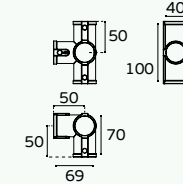

**IN.09.012**  
União / Union / Unión

MATERIAL: EN 1.4301 / AISI 304

ACABAMENTO / FINISH: RAW

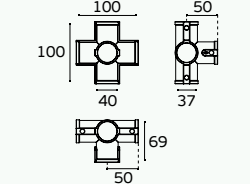

**IN.23.600.30.1000**  
**IN.23.600.30.2000**  
**IN.23.600.30.3000**  
Tubo / Tube / Tubo

MATERIAL: EN 1.4301 / AISI 304

ACABAMENTO / FINISH: RAW

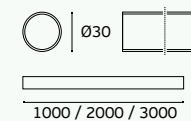

**IN.09.004.1**  
Tampa de remate /  
Finishing cap /  
Cubierta de remate

MATERIAL: EN 1.4301 / AISI 304

ACABAMENTO / FINISH: RAW

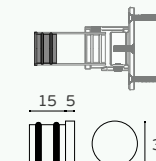

**IN.09.008**  
Reforço interior de tubo /  
Inner tube reinforcement /  
Refuerzo interior de tubo.

MATERIAL: ALUMINIO / ALUMINIUM

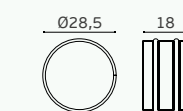

**IN.09.006**  
Base interior de fixação /  
Inner fixing base / Base interior fijación

MATERIAL: ALUMINIO / ALUMINIUM



**IN.09.007**  
Base interior de fixação /  
Inner fixing base / Base interior fijación

MATERIAL: ALUMINIO / ALUMINIUM





.TB



**IN.09.001.TB**  
Curva / Elbow / Curva

MATERIAL: EN 1.4301 / AISI 304

ACABAMENTO / FINISH: RAW

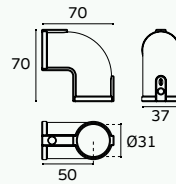

.TB



**IN.09.002.TB**  
União / Union / Unión

MATERIAL: EN 1.4301 / AISI 304

ACABAMENTO / FINISH: RAW

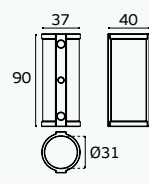

.TB



**IN.09.003.TB**  
Conector / Connector / Conector

MATERIAL: EN 1.4301 / AISI 304

ACABAMENTO / FINISH: RAW

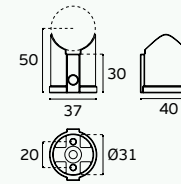

.TB



**IN.09.004.TB**  
Base / Base / Base

MATERIAL: EN 1.4301 / AISI 304

ACABAMENTO / FINISH: RAW

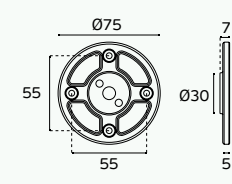

.TB



**IN.09.005.1.TB**  
Conector / Connector / Conector

MATERIAL: EN 1.4301 / AISI 304

ACABAMENTO / FINISH: RAW

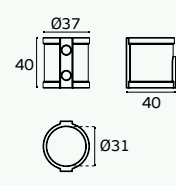

.TB



**IN.09.010.TB**  
União / Union / Unión

MATERIAL: EN 1.4301 / AISI 304

ACABAMENTO / FINISH: RAW

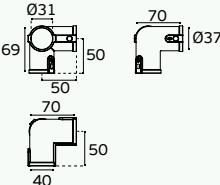

.TB



**IN.09.011.TB**  
União / Union / Unión

MATERIAL: EN 1.4301 / AISI 304

ACABAMENTO / FINISH: RAW

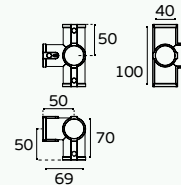

.TB



**IN.09.012.TB**  
União / Union / Unión

MATERIAL: EN 1.4301 / AISI 304

ACABAMENTO / FINISH: RAW

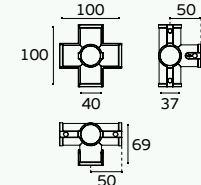

.TB

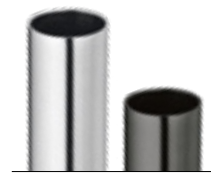

**IN.23.600.30.1000.TB**  
**IN.23.600.30.2000.TB**  
**IN.23.600.30.3000**  
Tubo / Tube / Tubo

MATERIAL: EN 1.4301 / AISI 304

ACABAMENTO / FINISH: RAW

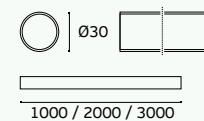

.TB



**IN.09.004.1.TB**  
Tampa de remate /  
Finishing cap /  
Cubierta de remate

MATERIAL: EN 1.4301 / AISI 304

ACABAMENTO / FINISH: RAW

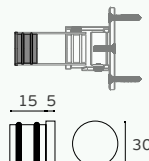

.TB



**IN.09.008**  
Reforço interior de tubo /  
Inner tube reinforcement /  
Refuerzo interior de tubo.

MATERIAL: ALUMINIO / ALUMINIUM

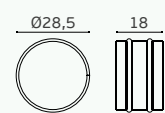

.TB



**IN.09.006**  
Base interior de fixação /  
Inner fixing base / Base interior fijación

MATERIAL: ALUMINIO / ALUMINIUM



**IN.09.007**  
Base interior de fixação /  
Inner fixing base / Base interior fijación

MATERIAL: ALUMINIO / ALUMINIUM







**IN.09.001.TG**  
Curva / Elbow / Curva

MATERIAL: EN 1.4301 / AISI 304

ACABAMENTO / FINISH: RAW

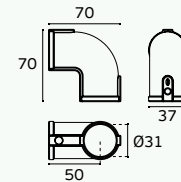

**IN.09.002.TG**  
União / Union / Unión

MATERIAL: EN 1.4301 / AISI 304

ACABAMENTO / FINISH: RAW

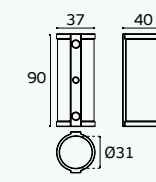

**IN.09.003.TG**  
Conector / Connector / Conector

MATERIAL: EN 1.4301 / AISI 304

ACABAMENTO / FINISH: RAW

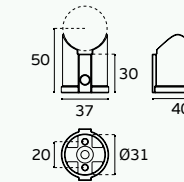

**IN.09.004.TG**  
Base / Base / Base

MATERIAL: EN 1.4301 / AISI 304

ACABAMENTO / FINISH: RAW

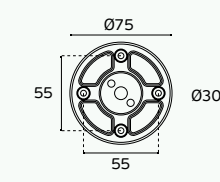

**IN.09.005.1.TG**  
Conector / Connector / Conector

MATERIAL: EN 1.4301 / AISI 304

ACABAMENTO / FINISH: RAW

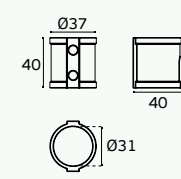

**IN.09.010.TG**  
União / Union / Unión

MATERIAL: EN 1.4301 / AISI 304

ACABAMENTO / FINISH: RAW

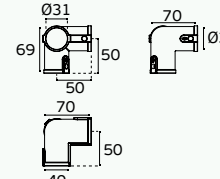

**IN.09.011.TG**  
União / Union / Unión

MATERIAL: EN 1.4301 / AISI 304

ACABAMENTO / FINISH: RAW

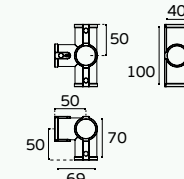

**IN.09.012.TG**  
União / Union / Unión

MATERIAL: EN 1.4301 / AISI 304

ACABAMENTO / FINISH: RAW

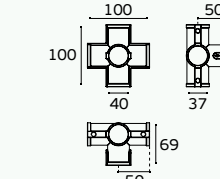

**IN.23.600.30.1000.TG**  
**IN.23.600.30.2000.TG**  
**IN.23.600.30.3000.TG**  
Tubo / Tube / Tubo

MATERIAL: EN 1.4301 / AISI 304

ACABAMENTO / FINISH: RAW

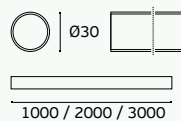

**IN.09.004.1.TG**  
Tampa de remate /  
Finishing cap /  
Cubierta de remate

MATERIAL: EN 1.4301 / AISI 304

ACABAMENTO / FINISH: RAW

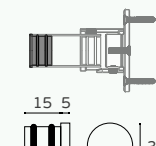

**IN.09.008**  
Reforço interior de tubo /  
Inner tube reinforcement /  
Refuerzo interior de tubo.

MATERIAL: ALUMINIO / ALUMINIUM

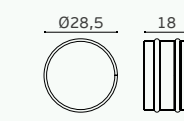

**IN.09.006**  
Base interior de fixação /  
Inner fixing base / Base interior fijación

MATERIAL: ALUMINIO / ALUMINIUM



**IN.09.007**  
Base interior de fixação /  
Inner fixing base / Base interior fijación

MATERIAL: ALUMINIO / ALUMINIUM



.TCO



**IN.09.001.TCO**  
Curva / Elbow / Curva

MATERIAL: EN 1.4301 / AISI 304

ACABAMENTO / FINISH: RAW

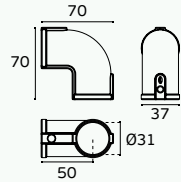

.TCO



**IN.09.002.TCO**  
União / Union / Unión

MATERIAL: EN 1.4301 / AISI 304

ACABAMENTO / FINISH: RAW

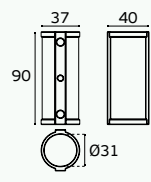

.TCO



**IN.09.003.TCO**  
Conector / Connector / Conector

MATERIAL: EN 1.4301 / AISI 304

ACABAMENTO / FINISH: RAW

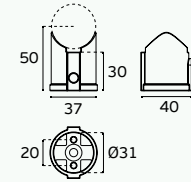

.TCO



**IN.09.004.TCO**  
Base / Base / Base

MATERIAL: EN 1.4301 / AISI 304

ACABAMENTO / FINISH: RAW

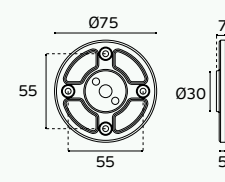

.TCO



**IN.09.005.1.TCO**  
Conector / Connector / Conector

MATERIAL: EN 1.4301 / AISI 304

ACABAMENTO / FINISH: RAW

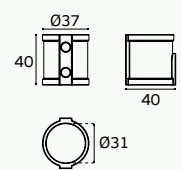

.TCO



**IN.09.010.TCO**  
União / Union / Unión

MATERIAL: EN 1.4301 / AISI 304

ACABAMENTO / FINISH: RAW

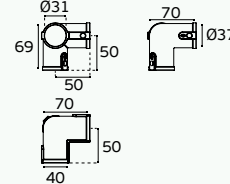

.TCO



**IN.09.011.TCO**  
União / Union / Unión

MATERIAL: EN 1.4301 / AISI 304

ACABAMENTO / FINISH: RAW

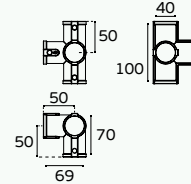

.TCO



**IN.09.012.TCO**  
União / Union / Unión

MATERIAL: EN 1.4301 / AISI 304

ACABAMENTO / FINISH: RAW

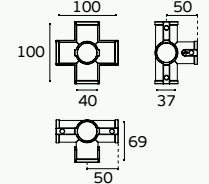

.TCO



**IN.23.600.30.1000.TCO**  
**IN.23.600.30.2000.TCO**  
**IN.23.600.30.3000**  
Tubo / Tube / Tubo

MATERIAL: EN 1.4301 / AISI 304

ACABAMENTO / FINISH: RAW

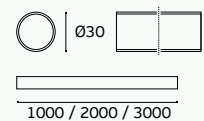

.TCO



**IN.09.004.1.TCO**  
Tampa de remate /  
Finishing cap /  
Cubierta de remate

MATERIAL: EN 1.4301 / AISI 304

ACABAMENTO / FINISH: RAW

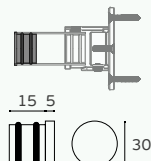

.TCO



**IN.09.008**  
Reforço interior de tubo /  
Inner tube reinforcement /  
Refuerzo interior de tubo.

MATERIAL: ALUMINIO / ALUMINIUM

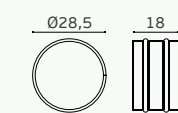

.TCO



**IN.09.006**  
Base interior de fixação /  
Inner fixing base / Base interior fijación

MATERIAL: ALUMINIO / ALUMINIUM



**IN.09.007**  
Base interior de fixação /  
Inner fixing base / Base interior fijación

MATERIAL: ALUMINIO / ALUMINIUM







**IN.09.004 + IN.09.003 + IN.09.002**

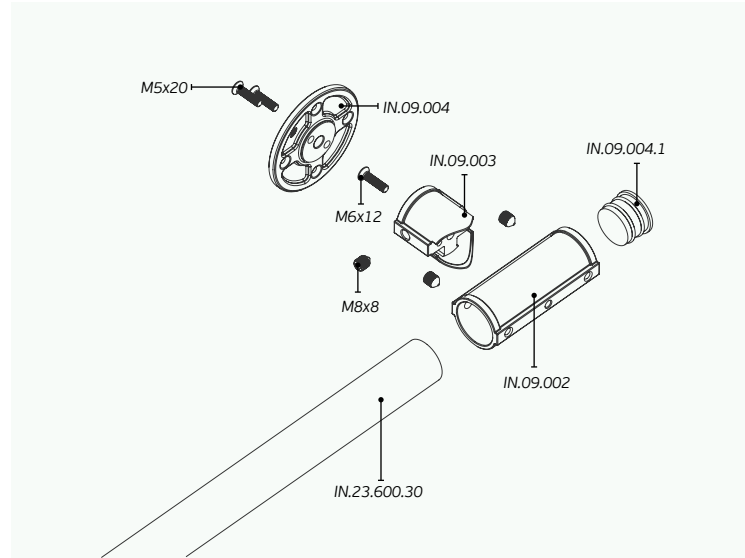

**IN.09.004 + IN.09.010**

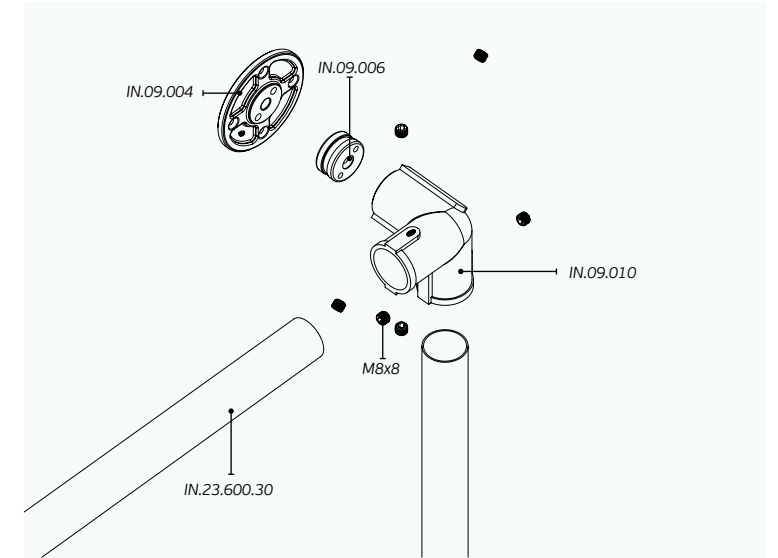

**IN.09.004 + IN.09.001**

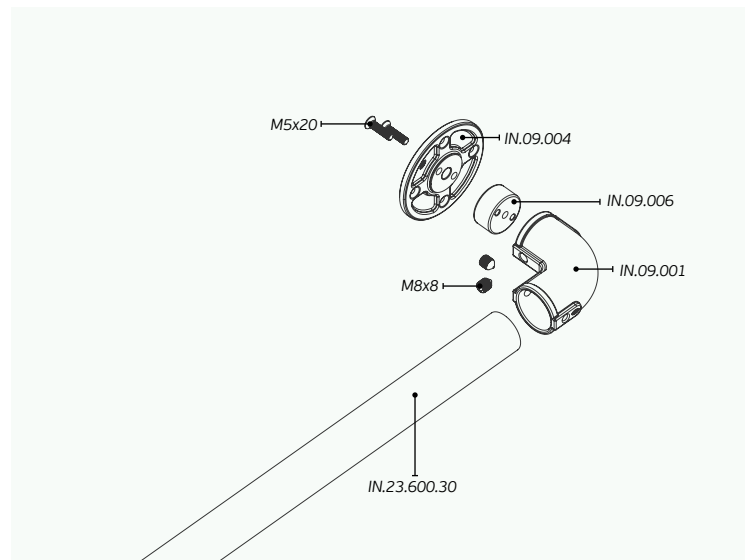

**IN.09.004 + IN.09.011**

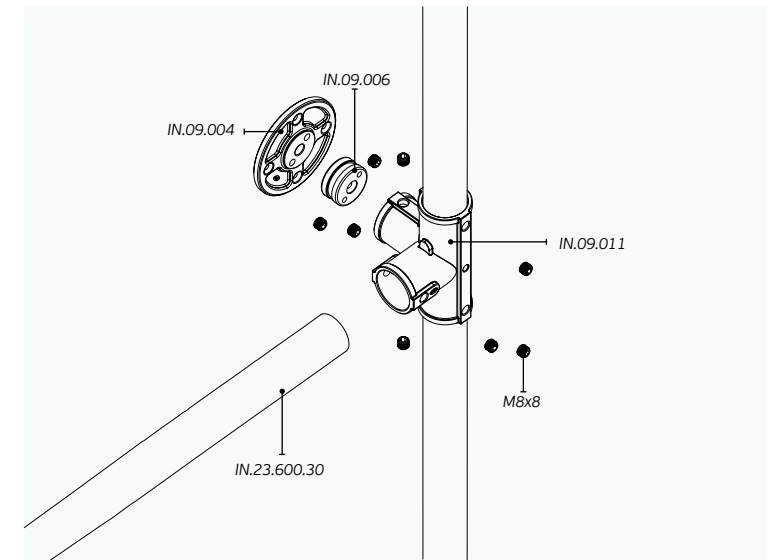

**IN.09.004 + IN.09.005**

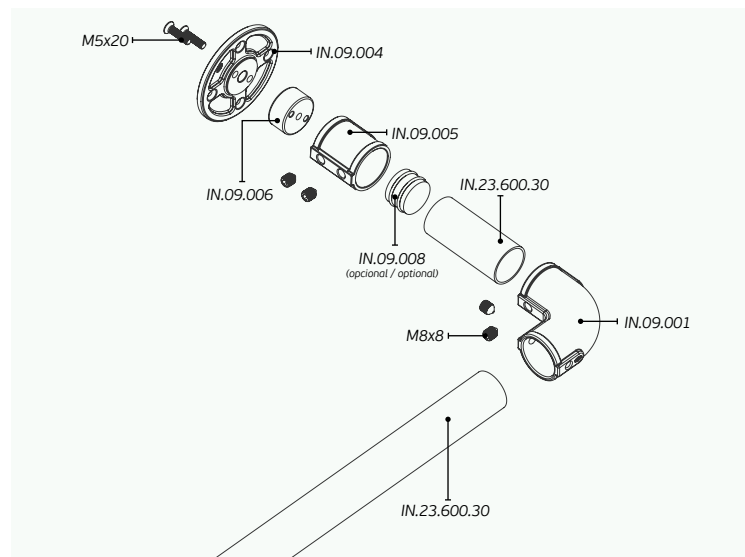

**IN.09.004 + IN.09.012**

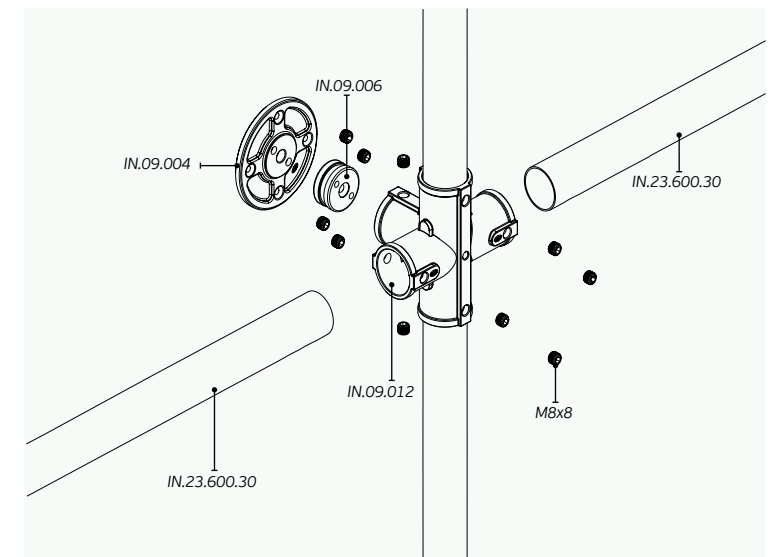





**IN.14.041.B**  
Cabide /  
Hook / Percha



MATERIAL: EN 1.4301 / AISI 304 + PELE / LEATHER / PIEL

ACABAMENTO / FINISH: PVD TITANIUM

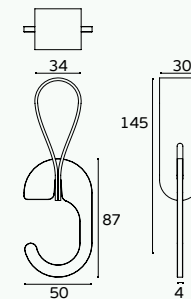

**IN.14.041.C**  
Cabide /  
Hook / Percha



MATERIAL: EN 1.4301 / AISI 304 + PELE / LEATHER / PIEL

ACABAMENTO / FINISH: PVD TITANIUM

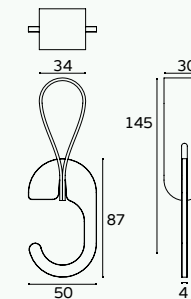

**IN.14.041.N**  
Cabide /  
Hook / Percha



MATERIAL: EN 1.4301 / AISI 304 + PELE / LEATHER / PIEL

ACABAMENTO / FINISH: PVD TITANIUM

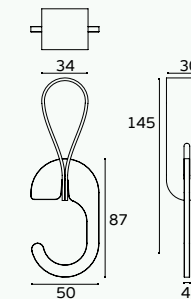

**IN.14.040.B**  
Cabide /  
Hook / Percha



MATERIAL: EN 1.4301 / AISI 304 + PELE / LEATHER / PIEL

ACABAMENTO / FINISH: PVD TITANIUM

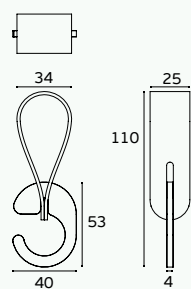

**IN.14.040.C**  
Cabide /  
Hook / Percha



MATERIAL: EN 1.4301 / AISI 304 + PELE / LEATHER / PIEL

ACABAMENTO / FINISH: PVD TITANIUM

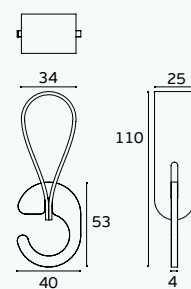

**IN.14.040.N**  
Cabide /  
Hook / Percha



MATERIAL: EN 1.4301 / AISI 304 + PELE / LEATHER / PIEL

ACABAMENTO / FINISH: PVD TITANIUM

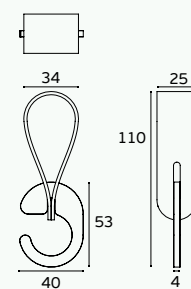



NEW



**IN.09.030**  
Prateleira para sistema CONNECT /  
Shelf for CONNECT system /  
Prateleira para sistema CONNECT

ACABAMENTO / FINISH: RAL 9005

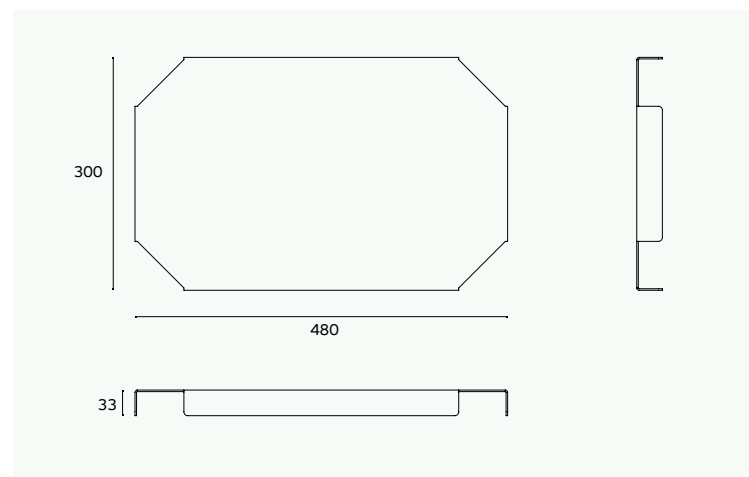

NEW

**IN.23.600.30.205**  
**IN.23.600.30.205.T**  
**IN.23.600.30.480**  
**IN.23.600.30.480.T**

Tubo para IN.09.030 (205mm e 480mm) /  
Tube for IN.09.030 (205mm and 480mm) / Tubo para IN.09.030 (205mm y 480mm).

MATERIAL: EN 1.4301 / AISI 304

ACABAMENTO / FINISH: RAW + PVD TITANIUM

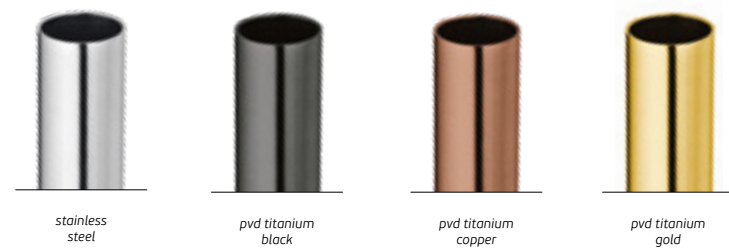





# THINK CONNECT BUILD

A IMAGINAÇÃO NÃO TEM LIMITES

IMAGINATION HAS NO LIMITS / LA IMAGINACIÓN NO TIENE LÍMITES



01

**Estante para livros**  
Book shelf  
Estante para livros

THINK

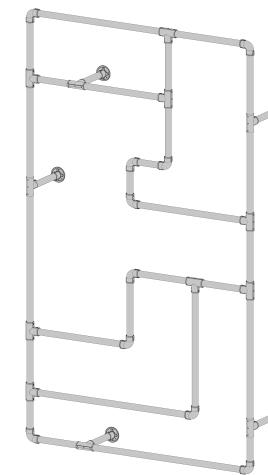

02

**Estante de parede**  
Wall shelf  
Estante de pared

CONNECT



03

**Cabide com estantes**  
Hanger with shelves  
Percha con estantes

BUILD

## PVD TITANIUM

Para além da utilização do aço inoxidável, também utilizamos acabamentos especiais não galvânicos e não poluentes, como é o caso do acabamento em titânio conseguido através da tecnologia PVD (Physical Vapor Deposition).

In addition to the use of stainless steel, we also use special non-galvanic and non-polluting finishes, such as the titanium finish achieved through PVD (Physical Vapor Deposition) technology. / Además del uso de acero inoxidable, también utilizamos acabados especiales no galvânicos y no contaminantes, como el acabado de titanio e MICROSAFETM logrado a través de la tecnología PVD (Physical Vapor Deposition).



# THINK CONNECT BUILD

A IMAGINAÇÃO NÃO TEM LIMITES

IMAGINATION HAS NO LIMITS / LA IMAGINACIÓN NO TIENE LÍMITES

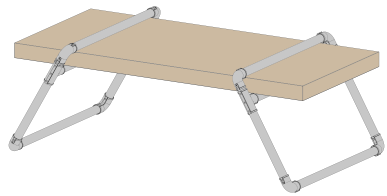

01

**Mesa**  
Table  
Mesa

THINK

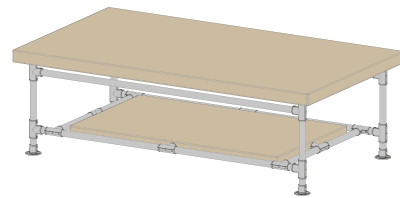

02

**Mesa com arrumação**  
Table with storage  
Mesa con almacenamiento

CONNECT

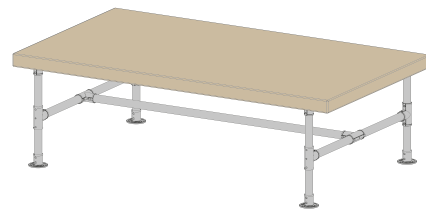

03

**Mesa**  
Table  
Mesa

BUILD

## PVD TITANIUM

**Para além da utilização do aço inoxidável, também utilizamos acabamentos especiais não galvânicos e não poluentes, como é o caso do acabamento em titânio conseguido através da tecnologia PVD (Physical Vapor Deposition).**

In addition to the use of stainless steel, we also use special non-galvanic and non-polluting finishes, such as the titanium finish achieved through PVD (Physical Vapor Deposition) technology. / Además del uso de acero inoxidable, también utilizamos acabados especiales no galvânicos y no contaminantes, como el acabado de titanio e MICROSAFETM logrado a través de la tecnología PVD (Physical Vapor Deposition).





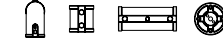

# THINK CONNECT BUILD

A IMAGINAÇÃO NÃO TEM LIMITES

IMAGINATION HAS NO LIMITS / LA IMAGINACIÓN NO TIENE LÍMITES

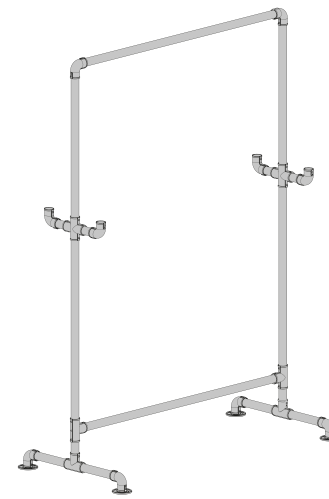

01

**Suporte para cabides**  
Clothes rack  
Colgadero

THINK

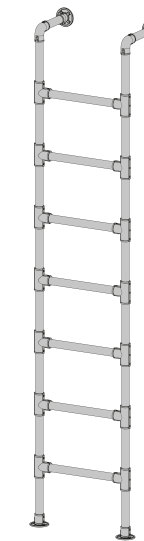

02

**Escada**  
Stair  
Escalera

CONNECT

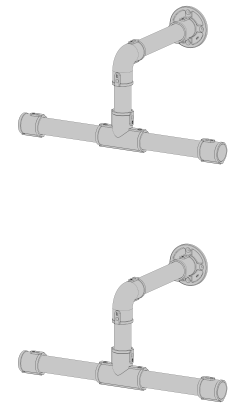

03

**Cabide de parede**  
Wall hook  
Percha para pared

BUILD

## PVD TITANIUM

Para além da utilização do aço inoxidável, também utilizamos acabamentos especiais não galvânicos e não poluentes, como é o caso do acabamento em titânio conseguido através da tecnologia PVD (Physical Vapor Deposition).

In addition to the use of stainless steel, we also use special non-galvanic and non-polluting finishes, such as the titanium finish achieved through PVD (Physical Vapor Deposition) technology. / Además del uso de acero inoxidable, también utilizamos acabados especiales no galvânicos y no contaminantes, como el acabado de titanio e MICROSAFETM logrado a través de la tecnología PVD (Physical Vapor Deposition).





# THINK CONNECT BUILD

**A IMAGINAÇÃO NÃO TEM LIMITES**

IMAGINATION HAS NO LIMITS / LA IMAGINACIÓN NO TIENE LÍMITES

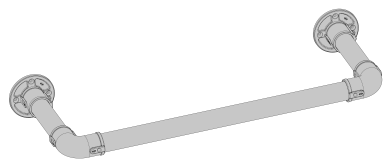

01

**Toalheiro**  
Towel Holder  
Toallero

THINK



02

**Asa de porta**  
Pull handle  
Manillones

CONNECT



03

**Asa para mobiliário**  
Furniture handle  
Pomo para mueble

BUILD

## PVD TITANIUM

**Para além da utilização do aço inoxidável, também utilizamos acabamentos especiais não galvânicos e não poluentes, como é o caso do acabamento em titânio conseguido através da tecnologia PVD (Physical Vapor Deposition).**

In addition to the use of stainless steel, we also use special non-galvanic and non-polluting finishes, such as the titanium finish achieved through PVD (Physical Vapor Deposition) technology. / Además del uso de acero inoxidable, también utilizamos acabados especiales no galvânicos y no contaminantes, como el acabado de titanio e MICROSAFETM logrado a través de la tecnología PVD (Physical Vapor Deposition).

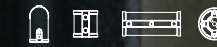



---

# ALWAYS MORE

## CONNECT SOLUTIONS

---

**AS ESPECIFICAÇÕES DOS PRODUTOS CONTIDOS  
NESTE CATÁLOGO PODEM SER ALTERADAS SEM  
AVISO PRÉVIO.**

*The technical specifications of the products  
contents in this catalogue can be changed without  
any previous advise.*

*Las especificaciones técnicas de los productos  
contenidos en este catalogo pueden ser  
cambiadas sin previo aviso.*

**A REPRODUÇÃO INTEGRAL OU PARCIAL DESTE  
CATÁLOGO NÃO É PERMITIDA.**

*The integral or parcial copy of this catalogue is not  
allowed.*

*La copia integral o parcial deste catalogo no es  
permitida.*

**O PRESENTE CATÁLOGO NÃO SEGUE AS REGRAS  
DO NOVO ACORDO ORTOGRÁFICO.**

---

CT-21.03.0

---







**ARCHITECTURAL  
HARDWARE**



---

#### **JNF PORTUGAL**

Head office / Factory

Comércio e Indústria de Ferragens S.A.  
Rua Mimosas 849/851,  
Zona Industrial Mimosas  
S. Pedro da Cova | Apartado 75  
4424-909 Gondomar, Portugal

**Tel: +351 224 663 230**

**[jnf@jnf.pt](mailto:jnf@jnf.pt)**

**[www.jnf.pt](http://www.jnf.pt)**

---

#### **JNF SOUTH AMERICA**

Office

Las verbenas 7946,  
Comuna Las condes  
Santiago de Chile

**Tel: +56 232 424 481**

**Tlm: +56 994 409 330**

**[jnf@jnf.cl](mailto:jnf@jnf.cl)**

**[www.jnf.cl](http://www.jnf.cl)**

---

#### **JNF SPAIN**

Office / Showroom

JNFmyStore  
Carrer Bruc, 77 Local dch.  
08009 Barcelona

**Tel: +34 932 504 047**

**Fax: +34 934 674 500**

**[jnf@jnfmystore.es](mailto:jnf@jnfmystore.es)**

**[www.jnfmystore.es](http://www.jnfmystore.es)**

---

#### **JNF ASIA**

Office / Showroom

Room A5, 7/F, Block A, Mai Hing Industrial  
Building, 16-18 Hing Yip Street, Kwun Tong,  
Kowloon, Hong Kong

**Tel : +852 3460 4031**

**Fax : +852 3013 9765**

**[jnf@sava.hk](mailto:jnf@sava.hk)**

**[www.jnf.hk](http://www.jnf.hk)**

---



[WWW.JNF.PT](http://WWW.JNF.PT)